



**Online Request for Tender (e-NIT)
For
Repair/Renovation of J&K bank branch at Diskit Nobra by way of
Composite works**

Tender is open only for J&K Bank's empanelled Composite Contractors.

**e-NIT Ref. No.: JKB/E&ED/Diskit-Nobra(Comp)/2025-1457
Dated : 11-07-2025**

Issued by:
J&K Bank Ltd.
Estates & Engineering Department,
Corporate Headquarters, Srinagar,
M. A. Road Srinagar, 190 001 J&K Tele: 0194- 2402665
email: engineering.chq@jkbmail.com

DISCLAIMER

The information contained in this Tender document or any information provided subsequently to bidder(s) whether verbally or in documentary form by or on behalf of the Bank is provided to the bidder(s) on the terms and conditions set out in this Tender document and all other terms and conditions subject to which such information is provided. This tender is neither an agreement nor an offer and is only an invitation by Bank to the interested parties for submission of bids. The purpose of this tender is to provide the bidder(s) with information to assist the formulation of their proposals. While effort has been made to include all information and requirements of the Bank with respect to the solution requested, this tender does not claim to include all the information each bidder may require. Each bidder should conduct its own investigation and analysis and should check the accuracy, reliability and completeness of the information in this tender and wherever necessary obtain independent advice. The Bank makes no representation or warranty and shall incur no liability under any law, statute, rules or regulations as to the accuracy, reliability or completeness of this e-NIT. The Bank may in its absolute discretion, but without being under any obligation to do so, update, amend, supplement or annul the information in this e-NIT.

OBJECTIVE OF PROPOSAL

The Tender Details are as under:

e-NIT Reference Number	JKB/E&ED/Diskit-Nobra(Comp)/2025-1457 Dated : 11-07-2025
Issuing Department Name	Estates & Engineering Department, Corporate Headquarters, M.A. Road, Srinagar 190001 J&K
Scope of Work	Execution of Composite works by way of, Tile flooring, Gyp partition, Gyp ceiling, Furniture and electrical and other allied works
e-Tender Details	Repair/Renovation of J&K bank branch at Diskit Nobra by way of Civil-interior, Furniture & Electrical works
BIDs Submission Mode	On-Line through Bank's e-Tendering Service Provider's Portal https://jkbank.abcpocure.com
Tender Type	Limited between Empanelled Contractors
Category	Category C and above of empanelled agencies of Composite Trade
Type of Contract	Works
Bidding Type	Indigenous
Base Currency	INR (₹)
Consortium	Consortium Bids are not allowed.
Contact details of concerned Department (Name, Designation, Mobile No., Email address for sending any kind of correspondence regarding this NIT)	<p>1. Mr. Inam ul Haq Keen (I/C Engineering Dept) CHQ Cell No: 9797795973 Email: inam@jkbmail.com</p> <p>2. Tawseef Nawaz Khan (Executive) Cell No: 9697518717 Email: Tawseef.khan@jkbmail.com</p> <p>3. Mr. Nisar Ul Nabi (Draftsman civil) Cell No: 9419027096 Email: nisar.nabi@jkbmail.com</p> <p>4. Mr. Yasir Hamid (Sr.Manager-Electrical) e-mail: Yasir.beg@jkbmail.com , Cell No. 9797792733</p> <p>5 Mr. Mujeeb Manzoor (A. Executive Electrical) Cell No:01942502666</p> <p>6 Imran Rashid (Civil) Cell no. 9596040972</p> <p>Dept. e-mail id:- engineering.chq@jkbmail.com</p>
Bid Document Availability including	NIT can be downloaded from and submitted on Bank's

changes/amendments, if any to be issued	e-Tendering Services Provider's Portal https://jkbank.abcprocure.com from July 15, 2025 16.00 Hrs. July 25, 2025 15.00 Hrs.										
Last Date for Pre-Bid Queries & submission Mode	All Clarifications / Queries shall be raised online only through e-Tendering Portal https://jkbank.abcprocure.com by or before July 18, 2025 17.00 Hrs.										
Pre-bid Queries Response date	All communications regarding points / queries requiring clarifications shall be given online through prescribed e-Tendering Portal on July 21, 2025										
Last Date of Submission of RFP Bid	July 25, 2025 15.00 Hrs.										
Date and Time for Eligibility/ Technical Bid Opening	To be notified separately										
Submission of online Technical Bid	As prescribed in Bank's online e-Tender Portal https://jkbank.abcprocure.com										
Tender Processing Fee (Non-Refundable)	Not Applicable										
Earnest Money Deposit (EMD) [Refundable]	No EMD is to be Deposited. However, a security deposit of 2 % of lowest bid amount is to be submitted by the successful bidder in the shape of CDR before a formal allotment is issued in his favour.										
Eligibility & Technical Criteria	Category 'C' and Higher of Composite empanelled agencies of the Bank.										
CORRIGENDUM	All the Corrigendum will be uploaded on online tender portal https://jkbank.abcprocure.com only										
For e-Tender related Queries	<p>Service Provider: M/s. E-procurement Technologies Limited (Auction Tiger) , B-705, Wall Street- II, Opp. Orient Club, Ellis Bridge, Near Gujarat College, Ahmedabad- 380006, Gujarat</p> <p>Help Desk:</p> <table border="1"> <thead> <tr> <th>Sr. No</th><th>Name</th></tr> </thead> <tbody> <tr> <td>1</td><td>Sandhya Vekariya - 6352631968</td></tr> <tr> <td>2</td><td>Suraj Gupta - 6352632310</td></tr> <tr> <td>3</td><td>Ijlalaehmad Pathan - 6352631902</td></tr> <tr> <td>4</td><td>Imran Sodagar - 9328931942</td></tr> </tbody> </table>	Sr. No	Name	1	Sandhya Vekariya - 6352631968	2	Suraj Gupta - 6352632310	3	Ijlalaehmad Pathan - 6352631902	4	Imran Sodagar - 9328931942
Sr. No	Name										
1	Sandhya Vekariya - 6352631968										
2	Suraj Gupta - 6352632310										
3	Ijlalaehmad Pathan - 6352631902										
4	Imran Sodagar - 9328931942										

INDEX

S.NO.	DESCRIPTION	Page No
1	NOTICE INVITING TENDER	6-9
2	INSTRUCTIONS FOR BIDDER	10
3	APPENDIX TO FORM OF TENDER	11
4	FORM OF AGREEMENT	12-14
5	GENERAL CONDITION OF CONTRACT	15-20
6	SPECIAL CONDITION OF CONTRACT	21
7	ANNEXURES for Specifications, BOQ-cum-Commercial / Price BID Formats,	22 onwards

(I) NOTICE INVITING TENDER

Tenders are hereby invited by AGM (BSD) on behalf of Jammu & Kashmir Bank LTD. Srinagar, J&K for the project:

Repair/Renovation of J&K bank branch at Diskit Nobra by way of Civil interior, Furniture, Electrical works (Composite works).

The Bidder should be an Empanelled Contractor with the J & K Bank in the relevant trade and category as prescribed for the work.

1. Estimated Cost of Work: Approximately **Rs.34.74 Lakhs.**
2. Detailed tender document consisting of Terms and Conditions, BOQ, Technical Specification, General Terms and Conditions etc. will be available through a link from the Banks website www.jkbank.com and will be forwarded to <https://jkbank.abcpocure.com>
3. The site for the work is available and should be inspected before quoting for this tender.

The time allowed for the carrying out of the work will be **120 Calendar days** from the date of issue of written orders/ email to commence the work, in a phased manner as decided by the Engineer In charge, J&K Bank Ltd., Srinagar.

4. The Bidders should digitally sign the tender in places indicated and the total amount tendered should also be written in the prescribed form.
5. The bid document is available online on the website <https://jkbank.abcpocure.com> The bid document can be downloaded free of cost, however, the successful bidder is required to submit a security deposit of specified amount in the shape of CDR at the time of formal allotment which will be valid till the validity of current empanelment or end of defect liability period whichever is later. The bidder would be required to register in the web site, which is free of cost. For submission of bids, the bidder is required to have valid Digital Signature Certificate (DSC) from one of the authorized Certifying Authorities (CA). Before the deadline for submission of bids, the J&K Bank may modify the bidding documents by issuing online corrigendum. The corrigendum will appear on the web page of the website <https://jkbank.abcpocure.com> under the "Latest Corrigendum".
6. Documents Comprising the Bid.
Only the price bid is to be uploaded online. No other document is to be submitted at the time of online bid.

A) Deadline for Submission of Bids

- Only Price Bid is to be uploaded by the Bidder online not later than the date and time indicated in the Appendix.
- To give prospective bidders reasonable time in which to take an addendum into account in preparing their bids, the J&K Bank shall extend, as necessary, the deadline for submission of bids. The J&K Bank may extend the deadline for submission of bids by issuing an amendment. In such case all rights and obligations of the J&K Bank and the bidders previously subject to the

original deadline will then be subject to the new deadline.

B) Bid Opening & Evaluation

Bid Opening

- The J&K Bank inviting the bids or its authorized representative will open the bids online and this could be viewed by the bidders online.

C) Award of Contract

Award Criteria

The Bank (J&K Bank) will award the Contract to the Bidder whose Bid has been determined:

(i) To be substantially responsive to the bidding documents and who has offered the lowest evaluated Bid price, provided that such Bidder has been determined to be :-

- Eligible in accordance with the provisions, and
- Qualified in accordance with the provisions; and

(ii) To be within the available bid capacity adjusted to account for his bid price which is evaluated the lowest.

J & K Bank reserves the right to accept or reject any Bid, and to cancel the bidding process and reject all bids, at any time prior to the award of Contract, without thereby incurring any liability to the affected Bidder or bidders or any obligation to inform the affected Bidder or bidders of the grounds for the Bank's action.

- The Bidder whose tender is accepted shall execute an Agreement on Rs. 100/- stamp paper reiterating the acceptance of his Execution of work on these item rates and conditions as set forth in the contract.
- J&K Bank Ltd. reserves the right to reject any or all the tenders without assigning any reason thereof.
- Taxes which are admissible for deduction shall be deducted at source at the rates admissible at the time of payment of the bill of contractors.
- The right of acceptance of a tender will rest with the **AGM BSD, J&K Bank Ltd., CHQ, Srinagar** who does not bind himself to accept the lowest tender and reserves with himself the authority to reject any or all the tenders received, without assigning any reason. Any tenders in whom any of the prescribed conditions are not fulfilled or are incomplete in any respect, are liable to be rejected.
- Canvassing in connection with tender is strictly prohibited and the tender submitted by a Bidder, who resorts to canvassing, is liable to be rejected.
- On acceptance of the tender, the name of the accredited representative(s) of the Bidder who would be responsible for taking instructions from the Engineer In Charge shall be communicated to the **Engineer In charge, J&K Bank Ltd., Srinagar**.
- Special care should be taken to write the rates in figures.
- The bidder has to bid for all works contained item wise in the BOQ. The Bank has reserved right to accept the whole or any part of the tender and the bidder shall be bound to perform the same at the rate quoted.
- The Bidder at the end shall add Goods & Service Tax separately which as per the government notification shall be payable at the time of payment with respect to the prevailing government

rates at that time. The individual rates filled in the Tender shall be exclusive of GST but inclusive of all material plus labour, delivery, transportation, handling, wastage, levies and the such and include ALL costs/overheads to be incurred by the Bidder for executing these works as per the drawings, details, specifications, with the care, expertise and post execution responsibilities outlined in this Tender. No additional claim over the rates shall be entertained later.

- 17 The Tender for the work includes the Composite works as per BOQs, drawings and directions of the Engineer In charge.
- 18 The Bidder shall inspect the site before submitting the tender.
- 19 The intending Bidder should not in any way quote more than one rate per item of work. In case the Bidder splits the quantity of any item of work and quotes more than one rate for the same, his tender will be rejected. The Bidders shall quote in figures as well as in words, the rates, & the amount tendered by them. The amount for each item should be worked out and the requisite totals be given.

Sd/-

AGM BSD

ELIGIBILITY CRITERIA AND CREDENTIALS

- The Bidder should be an empanelled Contractor of J & K Bank of **category C** or higher **of Composite works**.
- The Bidder should have minimum available Bid capacity/Financial Capability as required for the said work.

Should this tender be accepted in whole or in part, I/We hereby agree:

1. To abide by all terms and provisions of the said conditions annexed here to and all the terms and provisions contained in the Notice Inviting Tenders, so far as applicable and / or in default thereof to forfeit & pay to the Bank, by their successors the sum of money mentioned in the said conditions.
2. To execute all the works referred to in the tender documents upon the terms & conditions contained or referred to therein & to carry out such deviations as may be ordered up to a maximum of **50% (fifty percent)** of the tendered value at the rates quoted in the tender documents.

Digital Signature of Contractor before Submission of Tender

Witness.

1. _____

2. _____

Sd/-

AGM BSD

(II) INSTRUCTIONS FOR BIDDERS

1. Before e-BID, the Bidders, in their interest are advised to inspect and examine the site & its surroundings and satisfy themselves in respect of the site conditions as the Bank shall bear no responsibility for lack of acquaintance of the site and other conditions or any information relating thereto, on their part. The consequences of the lack of knowledge, as aforesaid, on the part of the Bidders shall be at their risk and cost.
2. Before tendering, the Bidders shall carefully examine the tender documents, general conditions of contract, special conditions of contract, specifications, drawings & other matters referred to therein, the schedules and Bill of quantities and if there should be or appear to be any ambiguity in or discrepancy between any of these documents or between figured and measured dimensions and other aspects upon the Drawings, he should immediately refer the matter in writing to the Engineer In charge for clarification.
3. Selection of the items according to specifications and approved makes will be as per the conditions of the contract and as per the drawing attached. All the items before installing should be approved from Engineer.
4. The Bank will not be responsible and will not pay for expenses which may be incurred or losses to person or property suffered by the Bidder in connection with visits to an examination of the site and in the preparation of his tender for submission.
5. The Bidder (whether or not he submits a tender) shall treat the details of the documents as secret and confidential.
6. The Bank reserves the right to adjust arithmetical or other errors in any tender in the way, which it considers suitable. Any adjustments so made by the Bank shall be stated to the Bidder if the Bank shall make an offer to accept the tender.
7. The Bank does not bind itself to accept the lowest or any tender and has the right to refuse or accept any tender without assigning any reason (s) thereof. The Bank shall also have right either to invite more Bidders for submitting tenders or re-issue the Tenders afresh at their own discretion for which the original Bidders shall have no right of objecting any action taken in this behalf by neither the Bank nor the Bank shall be bound to any explanation in this behalf.
8. All documents of the tender are to be read in conjunction with each other and Bidder shall take this aspect into consideration while quoting the rates.
9. It will be the responsibility of the successful Bidder to keep liaison with the Bank till finalization of Letter of Acceptance or within validity period. No excuse whatsoever will be entertained for not having received the allotment letter/Letter of Acceptance through post or otherwise.

(III) APPENDIX TO FORM OF TENDER

S.No	Particulars	Description
1	Earnest Money / Security Deposit:	No EMD for the Work. However, the successful bidder is required to submit a security deposit of 2% of lowest bid received in the shape of CDR at the time of formal allotment which will be valid till the validity of current empanelment or end of defect liability period whichever is later. The security deposit is to be submitted by the firm for the first successful bid only, which shall be valid for subsequent bids for other works also. The total security deposit (retention money + initial security deposit+ EMD) will be kept with the bank ,50% of the total security deposit amount shall be refunded without interest to the contractor on the issuance of virtual completion certificate by the Architect/Bank and the contractors removal of his material ,equipment ,labour force ,temporary sheds stores ,site office etc. and on receipt of physical possession of site by the bank .The remaining 50% of the total security deposit may be refunded 15 days after end of defect liability period provided he has satisfactorily carried out all the works and attended to rectification of all defects in accordance with conditions of the contract.
2	Period of commencement:	Date of issue of letter of acceptance or the date of handing over of site whichever is later.
3	Time of Completion	120 calendar days
4	Reverse Auction	The Tender shall be put to reverse auction after the last date of the submission of bids to get a final successful bidder and work shall be allotted to the lowest bidder after the reverse auction.
5	Liquidated damages for delay:	0.5% (Zero decimal five percent) of Gross Contract value per week or part thereof subject to a maximum 10% of contract value
6	Limit of liquidated damages	Up to a maximum of 10% (Ten percent) of Contract Value.
7	Defects Liability /Maintenance period	12 months from the date of issue of virtual completion certificate as issued by Engineer (As per Procurement Of Works policy Retention Clauses (

		Page no 12 , 13 & 31)
8	Retention Money	From each running bill, an amount at the rate of 10% of the gross value of the running bill shall be recovered as retention money .EMD & ISD shall also form the part of the retention money till deposit of 10% of the total contract value, this amount is called Total Security Deposit which consist of three components, EMD, ISD & RM. The total security deposit will be kept with the bank ,50% of the total security deposit amount shall be refunded without interest to the contractor on the issuance of virtual completion certificate by the Architect/Bank and the contractors removal of his material ,equipment ,labour force ,temporary sheds stores ,site office etc and on receipt of physical possession of site by the bank .The remaining 50% of the total security deposit may be refunded 15 days after end of defect liability period provided he has satisfactorily carried out all the works and attended to rectification of all defects in accordance with conditions of the contract
9	Quantities	Quantities as per BOQ liable to change as per work done at site.
10	Running Payments	Payments should be done on running bills or stage basis as per Annexure D
11	Final Payment	Final payment shall be done after completion certificate by the engineer and joint measurements with the contractor, subject to deductions.

FORM OF AGREEMENT
(On Stamp Paper 100/=)

ARTICLE OF AGREEMENT made at Srinagar this _____ day of Two Thousand Twenty five between J.K. BANK, having its Head office at Maulana Azad Road, Srinagar (J&K), through the AGM (BSD) hereinafter called "Bank" (which expression shall include its successors and assigns wherever the contract meaning shall so require or include its successors & assigns wherever the contract meaning shall so require or permit of the one part and M/s. _____) hereinafter called the "Contractor" of the other part.

WHEREAS the Bank is desirous of having provided and getting executed, completed and maintain certain works for **Repair/Renovation of J&K bank branch at Diskit Nobra by way of Civil-interior ,Furniture & Electrical works (Composite works)**, enumerated or referred to the Documents forming part of the "TENDER" and acceptance, copies of all of which hereto annexed are designed to form part of this contract and are included in term "CONTRACT" wherever herein used.

AND WHEREAS the Bank accepted the tender of the contractor for the provisions of execution, completion & maintenance of work under defect liability period of the above said work.

AND WHEREAS the individual rates filled in by the CONTRACTOR are exclusive of GST but inclusive of all material plus labour, delivery, transportation, handling, wastage, levies and the such and include ALL costs/overheads to be incurred by the CONTRACTOR for executing these works as per the drawings, details, specifications, of the Engineer with the care, expertise and post execution responsibilities outlined in this Tender. THE CONTRACTOR confirms that no additional claim over the rates shall be entertained later by THE BANK.

AND WHEREAS the contractor has agreed with the Bank to execute complete and maintain during the defect liability period subject to the conditions and instructions set forth herein (hereinafter referred to as "the said conditions") the works, shown upon the documents forming part of the contract as stated hereinafter, on the item rate basis & as set forth, amounting to the contract sum of Rs.(IN WORDS) (hereinafter referred to as "the said contract amount /Price/Sum").

NOW THIS AGREEMENT WITNESSETH AS FOLLOWS:

1. The terms and conditions laid down in the documents stated herein in the Clause shall be read and construed as forming part of this Agreement and the contractor shall abide by, terms and conditions, specifications and rates specified therein and perform agreement in accordance with such conditions".
2. The following documents shall be deemed to form and be ready and construed as part of this agreement:
 - a. The said tender and Appendix
 - b. Form of Tender
 - c. General conditions of Contract
 - d. The Special Conditions of Contract.
 - e. Specifications
 - f. Preamble to bill of quantities and priced bill of quantities as accepted.
 - g. The letter of Acceptance
 - h. Other additional documents as required

3. In consideration of the payment to be made by the Bank to the contractor for the work to be executed by him, the contractor does hereby agree with the Bank to provide, execute & complete the said work on or before the date mentioned in the time schedule of completion of work attached to the tender documents strictly as per the contract agreement and shall maintain the same at his own cost during the defects liability period , thereafter perform all such aspects and things in the contract mentioned or described or which are to be implied thereafter or may be reasonable necessary for the completion of the said works and at the time and the manner subject to the terms and conditions or stipulations mentioned in the contract.
- 4, In consideration of the due provisions, execution and completion of the said works the Bank does hereby agree with the contractor that the Bank will pay to the contractor the respective amount for the work actually done by him and such other sums as may become payable to the contractor under the contract. Such payment to be made at any such time & in such manner as provided for in the agreement.
- 5 All disputes arising out of or any way connected with this agreement shall be deemed to have arisen in J & K and only the courts at Srinagar shall have jurisdiction to determine the same.
6. The several parts of this contract have been ready by/to us and fully understood by us.
7. This Agreement shall come into effect on _____ (the effective date). The agreement shall remain in force for a **120 Calendar days from the said effective date till the envisaged timeframe for completion or actual date of completion whichever is later**
8. Bank shall be entitled to terminate this agreement in case of breach of any of the terms and conditions of this agreement and related tender documents after serving a notice of 20 days on the contractor.
9. That upon expiration or termination of this agreement for any reason whatsoever, the contractor shall; i) Immediately refrain from any action that would cause or may indicate any relationship between it and the bank . ii) Forthwith hand over to the bank, the possession of all the documents, material or any other property belonging to the bank that may be in its possession.
10. The bank reserve the right to terminate this agreement without assigning any reason thereof.
11. The contractor hereby agrees and undertakes to indemnify the bank and keep it indemnified against any loss or damage suffered by the bank on account of any act or omission on part of the contractor.
- 12 The provision of this agreement, which are intended to survive the term of this agreement by their very nature, shall survive the termination of this agreement. Notwithstanding, arbitration and applicable law and jurisdiction shall survive the termination/expiration of this agreement.
- 13 The Security deposit will be forfeited by the bank in case of breach of any of the terms and conditions of this agreement.

14 IN WITNESS WHEREOF, the parties have caused their respective common seals to be here unto affixed (or have here unto set their respective hands and seals) the day and the year first above written:

NAME_____

NAME_____

ON BEHALF OF THE BANK

1. SEAL

2 ADDRESS

In Presence of:

ON BEHALF OF THE CONTRACTOR

SEAL

ADDRESS

(v) GENERAL CONDITIONS OF CONTRACT

1. Extent of Contract

The contract comprises the construction, completion & maintenance of the works & except in so far as the contract otherwise provides, the provision of all labour, materials, constructional plant, temporary works & everything whether of a temporary or permanent nature required in and for such construction, completion & maintenance so far as the necessity for providing the same is specified in or reasonably to be inferred from the contract.

2. Letter of Intent / Acceptance / Award

Before signing of the contract, the Bank may issue by registered post or by otherwise, depositing at the registered office of the contractor, letter of Intent / Acceptance to enter into a contract with the contract for the execution of the works in accordance with the contract. Upon issue of such Letter of Acceptance / Intent by the Bank, the Bank shall be deemed to have signified his intention to award the contract, however, the process shall be deemed to be complete only when the contract has been entered into by the Bank & the contractor. However, until a formal contract agreement is prepared & executed, the tender together with the Bank's letter of intent shall constitute a binding contract between the parties, provided the Security Deposit as required under the contract shall have been furnished by the contractor

3. Contract Agreement

Within 10 days after the issue of letter of acceptance, the contractor shall have to enter into a written deed of agreement incorporating all the terms & conditions as embodied in the Tender Documents or modified subsequently in writing and those contained in the letter of acceptance, with the Bank. The contractor shall not sub-contract the work without written permission of the Bank.

The following documents shall be deemed to form and be ready and construed as part of the contract agreement.

- a) The said Tender & Appendix
- b) Form of Tender
- c) General Conditions of Contract
- d) Special conditions of Contract
- e) Letter of Acceptance
- f) Contract Price
- g) Priced bill of quantities as accepted.
- h) Specifications
- i) Drawings
- j) Other additional documents as required.

4. Language (s)

The language in which the contract documents shall be drawn up shall be English.

5. Documents Mutually Explanatory

Except if & to the extent otherwise provided by the contract, the provisions of the conditions of contract shall prevail over those of any other document forming part of the contract. Subject to the foregoing, the several documents forming the contract are to be taken as mutually explanatory of one another but in case of ambiguities or discrepancies, the same shall be explained & adjusted by the Site Engineer who shall thereupon issue to the contractor instructions directing in what manner the work is to be carried out.

6. Contractor's General Responsibilities

The contractor shall, subject to the provisions of the contract, and with due care & diligence, execute, complete & maintain the works & provide all labour including Supervision, materials, constructional plant & all other things, whether of a temporary or permanent nature, required in and for such execution, completion & maintenance so far as the necessity for providing the same, excluding those to be provided by the Bank is specified in, or is reasonably to be inferred from the contractor. Temporary electric, water charges & any other extra charges shall be paid by the contractor & nothing shall be paid by the Bank.

The contractor shall carry out and complete and maintain the works in accordance with accepted good engineering practices and using materials and workmanship of the quality and standards therein specified provided that where and to the extent that approval of the quality of materials or of the standards of workmanship is a matter of option, such quality & standards shall be to the satisfaction of the Bank or Engineer in Charge or his Representative.

7. Safety of Site Operations

The contractor shall take full responsibility for the safety, stability and adequacy of all site operations and methods of construction including all temporary works, provided that the contractor shall not be responsible, except as may be expressly provided in the contract, for the design or specification of the permanent works.

8. Absence of Specification

If the specifications do not contain particulars of materials and works which are obviously necessary for the proper completion of the works, and the intention to include, which is inferred, all such materials and works shall be supplied and executed by the contractor without extra charge. If the contractor requires additional information, he shall, so request in writing, well in advance to commencement of the particular work, to the Engineer Incharge who will issue such detailed information as necessary within a reasonable time.

If, however, during the execution of the works, the contractor shall encounter physical conditions or obstructions constituting Force Majeure and which could not have been reasonably foreseen by an experienced contractor, the contractor shall forthwith give written notice thereof to the Engineer In Charge / Engineer's representative within two weeks after its occurrence and if in the opinion of the Engineer In Charge, such conditions or obstructions until so instructed by the Engineer In Charge except in the event of there being an urgent need to undertake remedial or other works or repairs to reduce risks of injuries or damages to persons or property.

9. Obtaining Information related to execution of work

No claim by the contractor for additional payment will be entertained which is consequent upon failure on his part to obtain correct information as to any matter affecting the execution of the works nor will any misunderstandings or the obtaining of incorrect information or the failure to obtain correct information relieve him from any risks or from the entire responsibility for the fulfillment of the contract.

10. Work to be to the satisfaction of Bank

The contractor shall execute, complete and maintain the works in strict accordance with the contract to the satisfaction of the Bank & shall comply with and adhere strictly to the Engineer's instructions and directions on any matter (whether mentioned in the contract or not) touching or

concerning the works. The contractor shall take instructions and directions only from the Engineer. All execution of works & materials should be as per tender specifications. Materials for which specification is not given in tender in that case prior approval from the bank. Contractor is strictly advised not to use sub standard materials. And if any sub standard material is used or found then a penalty of two times the difference in cost of standard material less sub standard material must be collected from the vendor/ sub contractor. i.e.; $\text{Penalty} = 2 \times (\text{Cost of Standard Material} - \text{Cost of Sub Standard Material})$ or bank have the right to hold the cost of that particular item and entire amount of the project will not be paid.

11. Night or Sunday Work

As the site is in a crowded market, keeping in view the sensitivity of the site, the contractor can be asked to do the work at night, by special order, the contractor would be required to carry out the work at night, without conferring any right on the contractor to claim extra payment for night working. The decision of the Engineer in charge in this regard will be final and binding on the contractor.

12. Corrupt and Fraudulent practice.

- It is required that Bidders observe the highest standard of ethics during the procurement and execution of such contracts and not to indulge in any corrupt and fraudulent practice.
- "Corrupt Practice" means the offering, giving, receiving or soliciting of anything of value to influence the action of an official in the procurement process or in contract execution.
- "Fraudulent Practice" means a misrepresentation of facts in order to influence a procurement process or the execution of contract to the detriment of the Bank and includes collusive practice among Bidders (prior to or after bid submission) designed to establish bid prices at artificial non-competitive levels and to deprive the Bank of the benefits of free and open competition.
- The Bank reserves the right to reject a proposal for award if it determines that the Bidder recommended for award has engaged in corrupt or fraudulent practices in competing for the contract in question.
- The Bank reserves the right to declare a Bidder ineligible, either indefinitely or for a stated period of time, to be awarded a contract if at any time it becomes known that the firm has engaged in corrupt or fraudulent practices in competing for or in executing the contract.

13. Liquidated Damages:

Should the work not be completed to the satisfaction of the Site Engineer within the stipulated period due to Contractors default, the contractor shall be bound to pay to the Bank, a sum calculated as below by way of liquidated damages and not as penalty during which the work remains uncommenced or unfinished after the expiry of the completion date.

If the contractor fails to complete the work by the scheduled date of completion or within any sanctioned extended time, he will have to pay liquidated damages at rate of 0.5 % of the contract value for each week of delay subject to maximum of 10 % of the contract value.

14. Force Majeure:

- i. The Selected Bidder shall not be liable for forfeiture of its performance security, Liquidated damages or termination for default, if any to the extent that its delay in performance or other failure to perform its obligations under the contract is the result of an event of Force Majeure.

- ii. For purposes of this Clause, "**Force Majeure**" means an event explicitly beyond the reasonable control of the Contractor and not involving the contractors fault or negligence and not foreseeable. Such events may be due to or as a result of or caused by act of God, wars, insurrections, riots, earth quake and fire, revolutions, civil commotion, floods, epidemics, quarantine restrictions, trade embargos, declared general strikes in relevant industries, satellite failure, act of Govt. of India, events not foreseeable but does not include any fault or negligence or carelessness on the part of the parties, resulting in such a situation. In the event of any such intervening Force Majeure, either party shall notify the other in writing of such circumstances or the cause thereof immediately within five calendar days.
- iii. Unless otherwise directed by the Bank in writing, the selected contractor shall continue to perform its obligations under the Contract as far as is reasonably practical, and shall seek all reasonable alternative means for performance not prevented by the Force Majeure event.
- iv. In such a case the time for performance shall be extended by a period(s) not less than duration of such delay. If the duration of delay continues beyond a period of three months, the Bank and the contractor shall hold consultations in an endeavor to find a solution to the problem.
- v. Notwithstanding above, the decision of the Bank shall be final and binding on the contractor regarding termination of contract or otherwise."

15. Available Bid Capacity/Financial Capability:

The bidder should possess the bidding capacity as calculated by the specified formula. The formula generally used is:

Available bid capacity = (A x M x N) - B, where

A = Maximum value of engineering (Civil/ Electrical/ Mechanical as relevant to work being procured) works executed in any one year during the last five years (updated at the current price level), taking into account the completed as well as works in progress.

M = Multiplier Factor (usually 1.5)

N = Number of years prescribed for completion of the work in question.

B = Value (updated at the current price level) of the existing commitments and ongoing works to be completed in the next 'N' years.

All costs and expenses incurred by interested bidders in any way associated with the development, preparation and submission of responses, including but not limited to the attendance at meetings, discussions etc. and providing any additional information required by the Bank, will be borne entirely and exclusively by the Bidder.

16. Electronic Reverse Auction.

The said work shall be put to electronic reverse auction before opening of the financial bids. Electronic Reverse Auction is a type of auction where the starting price, bid decrement, duration of auction, maximum number of automatic extensions are announced before start of online reverse auction. The shortlisted bidders shall after the start of RA start bidding online in an iterative process wherein the lowest bidder at any given moment can be displaced by an even lower bid of a competing

bidder, within the duration of the RA. If a new lower bid is received within last few minutes (say two minutes) of closing time, the closing time may get automatically extended by few minutes (at least five minutes) for others to respond. Maximum number of such extensions may be stipulated (at least five). The most favorable bid at the end of stipulated/extended time will be declared as successful. The Reverse Auction shall be scheduled for a fixed time period. Auctions may be arranged in any combination of time periods for e.g. (a) 1-1/2 hour viz. 1 hour with 6 extensions of 5 minutes each or (b) 1 hour viz. 1/2 hours with 6 extensions of 5 minutes each or (c) Unlimited extensions viz. 1/2 hour with unlimited extensions of 5 minutes each.

All the price bids (Indicative bids) submitted by the vendors shall be kept sealed to the event of e-reverse auction. At the end of reverse auction process the lowest Bidder (L1) will be selected on the basis of Total Price, including taxes.

In case the Prices arrived after Reverse Auction are more than the Indicative prices of any of the vendors, The Lowest Indicative prices of the vendor shall be considered and that vendor shall be declared the Lowest Bidder.

Bidding Example:

The final rates of the items shall be calculated in ratio of total amount quoted by the lowest bidder through reverse auction process and the amount quoted in indicative price bid, wherever specified in tender.

Example:

Indicative Price Bid submitted by vendor:

Item	Rate ®	Qty	Amount
A	100	2	200
B	200	3	600
C	300	4	1200
Total amount in Indicative price Bid			2000/-

The total amount mentioned in indicative price bid is Rs 2,000.00, but the final L-1 amount quoted by the vendor through E-reverse auction is Rs.1,600.00, then the K factor for L-1 vendor will be calculated as under

Ratio K= (Total amount quoted by the lowest bidder through reverse auction process) / (The amount quoted in indicative price bid)

$K = 1600 / 2000 = 0.8$.

The item wise final price to be confirmed by the vendor shall be as under:

Item	Final Rate= K*R	Qty	Amount
A	100×0.8	2	160
B	200×0.8	3	480
C	300×0.8	4	960
Total amount worked out after e- reverse auction			1600/-

17. After execution of the agreement with the successful bidder the relation of parties will be on principal to principal basis.

18. The Bidder shall not assign or outsource the works awarded by the Bank without the written consent of the Bank.

19. The successful bidder shall indemnify and keep J & K Bank, its Officers, Directors, employees indemnified in respect of any loss, damage or claim howsoever arising out of or related to breach of contract, statutory duty or negligence by the firm or its staff, agents in relation to the performance or otherwise of the services to be provided under the contract.

20. **Dispute resolution/arbitration:** In the case of any dispute arising upon or in relation to or in connection with this agreement between parties, the disputes shall at the first instance be resolved

through negotiations. If the dispute cannot be settled amicable within fourteen (14) days from the date on which either party has served written notice on the other of the dispute then any party can submit the dispute for arbitration under arbitration and conciliation Act, 1996. The sole Arbitrator shall be chosen by the bank.

The Place of Arbitrations shall be Jammu, India and the language of the arbitration proceedings and that of the documents and communication between the parties shall be English.

The Decision of the Arbitrator shall be final and binding upon the parties. The expenses of the arbitrator as determined by the arbitrator shall be borne equally.

The parties shall continue to be performing their respective obligation under this Agreement, despite the continuance of the arbitration proceedings, except for the disputed part under arbitration.

21. Each Bidder having responded to this NIT acknowledges to have read, understood and accepts the selection & evaluation process mentioned in this NIT documents. The bidder ceases to have any option to object against any of these processes at any stage subsequent to submission of its responses to this NIT.

22. All Notices or Communications under this software maintenance Agreement shall be first sent to E-mail to such e - mail addresses designated by each party, followed by registered post with acknowledged, where appropriate and required, to the address of each party first written above. A successful e mail delivery shall be treated as sufficient and complete delivery of the notice or communication. A notice by post will be sent by registered post acknowledge to the address set forth below, or such other address as it shall hereafter designate for this purpose:

In the case of a notice to the bank to:engineering.chq@jkbmail.com

In the case of a notice to contractor: email address registered with the bank.

Such notices shall be deemed to be received within four working days of the same being sent.

23. Bank reserves the right to select the next ranked bidder, if after selection the selected bidder withdraws his offer or bank detects wrong or misleading information in the proposal, In case the selected bidder withdraws his offer or if it is found that the information furnished by the bidder is wrong and misleading. Bank reserves right to take action as it deems fit, including forfeiture of EMD, claim for damages against the bidder.

(VI) SPECIAL CONDITIONS OF CONTRACT

1. If the Bank feels necessity of amending the specifications and or installing of any equipment / material which have not been quoted for by the contractor, the same shall have to be installed by the contractor which shall be paid as per actuals based on LMR and analyzed as per CPWD Schedule of Rates and analysis.
2. The commercial Bids of only those contractors / firms who qualify the prequalification laid by the Bank shall be considered.
3. The work shall be carried out strictly according to the terms & conditions, specification, design, drawing and plans. Where specifications do not cover any item, the specifications, terms and conditions of **UT** PWD / CPWD/ PDD in force shall be made applicable. All other terms and conditions not covered but in vogue in the CPWD shall hold good and form a part of the e-NIT.
4. No advance payment in the form of site mobilization advance, material advance etc. will be paid to Contractor. Running payments will be released after satisfactory completion of the portion of the works and measurement.
5. All other terms and conditions not covered but in vogue in the CPWD shall hold good and form a part of the e-NIT.
6. In the event of contract failure Bank reserves the right to terminate the contract after giving 20 days clear notice to the contractor and recover the amount of the loss caused by the damage, failure, default (including the consequently damage) as may be determined by The AGM BSD J&K Bank or his authorized representative.

(VII) ANNEXURES

- a) SPECIFICATION AND BOQ FOR COMPOSITE WORK.**
- b) LIST OF APPROVED MAKES.**
- c) PRICE / COMMERCIAL BID FORMAT FOR COMPOSITE WORKS.**

Annexure A

SPECIFICATIONS, BOQ FOR COMPOSITE WORKS

BOQ/Specifications for Repair/Renovation of J&K bank branch at Diskit Leh by way of Civil interior, Furniture& Electrical (Composite works)			
S. No.	PARTICULARS OF ITEMS	Unit	Quantity
	A) Dismantling of Existing Gyp Partition Quantity	SFT	783.62
	B) Dismantling of Existing Floor tile /Wall tiles	SFT	1,874.62
	C) Removing of existing Panelled /Glazed/ Flush doors doors v	SFT	147.00
	D) Dismantling of Existing brick work/block work	CUM	3.00
1	Cement Concrete		
	Providing and laying of cement concrete with crushed stone aggregates (quarry) 20mm nominal size including curing but excluding form work.		
	A) 1:3:6 (1 cement : 3coarse sand : 6 crushed stone aggregate 20mm n/s)	Cu m	9.00
	B) 1:1.5:3 (Crushed stone 20mm nominal size)	Cum	0.73
2	Steel reinforcement for R.C.C. work including straightening, cutting, bending, placing in position and binding all complete upto plinth level (Cold twisted bars)	Kgs	47.00
3	Centering and shuttering including strutting, propping etc. and removal of form work for: Foundations, footings, bases for columns	SQM	1.00
4	Providing and laying of stone soling/boulders tightly handpacked under foundations, footings etc. including carraiges of materials from source to site of work- complete in all respects----Including Compaction	CUM	2.00
5	Solid Block masonry work		
	Providing and fixing upto floor five level precast cement concrete solid blocks including hoisting and setting in position in cement motor 1:3 (1 cement : 3 coarse sand , cost of required centering, shuttering and curing complete.(1:3:6) mix of solid block	Cum	9.00
6	Plaster Works		

	CEMENT 12mm 1 : 6 (1 cement : 6 fine sand)	PLASTER Cement (IN plaster FINE of SAND) mix:		SQM	115.0
7	Vitrified Tiles				
	Providing and laying full body glazed polished vitrified tile free from all visible defects of size 600x600 (thickness to be specified by manufacturer) with water absorption less than 0.5% and conforming to ISO 13006:2018 of approved make Kajaria or RAK or Johnson and approved shade (Kajaria Shade 6603, Salt & Pepper (series Stonegres) or RAK (Coarstone Crema) or Johnson (S&P Beige) laid on 20mm thick cement mortar 1:4 (1 cement : 4 coarse sand) in all shapes & patterns and skirting (4"- to be measured in SFT) with cement mortar or chemical -complete job.				1731.00
	SFT				
	B) Same as above "A" in Skirting 4 " Height				348.00
	RFT				
8	Ceramic Tiles				
	P/L of Ceramic Tiles free from all visible defects walls tiles of size 450x300mm and matching floor 300 x 300mm of 1st quality confirming to IS: 13755, KAJARIA, Hindware, Johnson laid over a 20mm thk bed of cement mortar 1:4 (1 Cement (ACC, Ambuja, ultratech or eq) :4 Corase sand) including pointing the joints with white cement and matching pigment etc. complete				439.00
	SFT				
9	POP WORKS				
	Providing and doing 6mm thick POP over walls only				2,164.00
	SFT				
10	Gyp Ceiling				
	P/F of gyp board ceiling (Gyproc, USG Boral or eq) 12.5 mm thk over frame work with G.I suspended metal galvanised frame work and hangers of appropriate design with section spaced at 450 mm max. with intermediate supports spaced at 1220mm max in ceiling and jointing / taping the gyp in a manner to give a seamless look- all complete				1,650.00
	SFT				
11	Partition, Gyp Finish				
	P/F of Partition having composite thickness of 99mm consisting of frame and double skin 12mm thk plywood (Century (Sainik), Greenply (Ecotec), Archidply, and also double skin 12.5mm thk gypsum board (Gyproc, USG Boral or eq), including P/F of frame work made of fir wood/ pinewood/hardwood of 2" x 1.5" section fixed to floor/ ceiling at a spacing of 600mm c/c by 6mm dia nuts and bolts and studs at both ends - complete job including jointing / taping the gyp in a manner to give a seamless look- all complete.				367.00
	SFT				
12	Providing and Doing 1mm thick Wall putty over Gyp ceiling and Gyp Partition				
	SFT				2,384.00

13	P/f of frame work of fir wood / pinewood / hardwood for connecting gyp partitions to ceiling spaced at 600mm c/c, section of wood 2"x1.5" complete job including nuts, bolts and studs, labour and material. (Works above false ceiling level)	SFT	56.00
14	P/F of Beeding (3.5 inches wide) on the joints of gyp and glass in partitions made out of 4mm thick American walnut veneer (Make Century, Billion Maglo, Greenply or Eq) duly polished in melamine of approved color - complete job including cost of materials and labour	RFT	140.00
15	Providing and fixing of half glazed and half laminated shutter for doors using 5mm thick float glass panes having stiles and rails made of 1st class seasoned kail wood finished in malimine polish with necessary screws and ISI marked M.S. pressed butt hinges	SFT	75.00
16	P/F of float glass in doors , windows and furniture tops but excluding moulding, grinding, itching etc. 12 mm thickness	SFT	122.00
PAINTING AND FINISHING WORKS			
17	Applying three coats of <u>plastic emulsion (Morning Glory Shade no 0765 & (TWINKLING STARS SHADE NO 8466) of approved brand to give an even shade and color after thoroughly brushing the surface, clean of all greaze and dirt, loose pieces of seals including preparing the surface with sand paper smooth (complete job including cost of materials and labour)</u>		
	A) With Priming Coat	Sq.M	452.00
18	Painting with synthetic enamel paint of approved brand and manufacture to give an even shade. Two or more coats on new work		
	A) With Priming Coat	Sq.m	24.00
19	Finishing walls with acrylic smooth exterior paint of required shade on New work (Two or more coats applied @ 1.67 liter/10sqm over and including priming coat of exterior primer applied @2.20kg/10sqm)		
	A) With Priming Coat	Sq.M	120.00
PLUMBING AND SANITARY WORKS			
20	Sanitary items		
1	Providing and fixing vitreous china wash basin including making all connections but excluding the cost of fittings, Flat back wash basin of size 630x450 mm (White Shade, Make Cera, Hindware, Parryware or eq)	No.	1.00
2	Supply, installation, testing and commisioning of hot water electrical operated Geyser of approved make, should have minimum three Star Rating, Auto off Function, inner tank should be of Stainless steel with Glass lined coating, Body: Metallic/Acrylonitrile butadiene styrene, 2 Year Warranty on electrical parts and heating element, 5 yer warranty on inner tank, Inlet & Outlet connector of water should be of brass (Venus, Crompton, Havells, Bajaj, Racold, Jaquar, Morphy Richards or eq)		
	i) Capacity 35 ltrs	No.	2.00
	ii) Capacity 25 ltrs	No.	0.00

3	CP Wall / Basin Mixer (Jaquar(continental), Hindware, Cera (Ocean) or eq)	No.	4.00
4	CP Angle valve (Jaquar(continental), Hindware, Cera (Ocean) or eq)	No.	8.00
5	C P Gratting (Jaquar(continental), Hindware, Cera (Ocean) or eq)	No.	2.00
6	C P Towel Ring (6" Dia) (Jaquar(continental), Hindware, Cera (hera) or eq)	No.	2.00
7	C P Towel Rod (1' - 6" length) (Jaquar(continental), Hindware, Cera (Oakla) or eq)	No.	2.00
8	Beab Cock, long nose / short nose (Jaquar(continental), Hindware, Cera (Ocean) or eq)	No.	2.00
9	Tissue paper Holder (Jaquar(continental), Hindware, Cera (aromond) or eq)	No.	2.00
10	PVC Cistern (White Shade), (Jaquar(continental), Hindware, Cera (Ocean) or eq)	No.	2.00
11	PVC Connections (15mm Dia) 1' -6" Length	No.	8.00
12	CP Cups (Jaquar(continental), Hindware, Cera (Ocean) or eq)	No.	7.00
13	CP Soap Case (Jaquar(continental), Hindware, Cera (Oakla) or eq)	No.	3.00
14	CP Hanger (6 No. Hooks) (Jaquar(continental), Hindware, Cera (armond) or eq)	No.	2.00
15	5mm mirror fixed on spacers	No.	1.00
16	CP Long Bend	No.	2.00
17	PVC Waste Pipe	No.	2.00
18	PVC P _ Trap (4") (B- Type, Finolex, Astral, Prince, Supreme or eq)	No.	2.00
19	PVC Floor Trap(3") (B- Type, Finolex, Astral, Prince, Supreme or eq)	No.	3.00
20	Health Faucet (Jaquar, Hindware, Cera or eq)	No.	2.00
21	Indian WC White shade (Parryware, Hindware, Cera or eq)	No.	2.00
22	Glass shelf below mirror	No.	2.00
23	CP waste Coupling	No.	2.00
24	4" PVC Pipes (B- Type) PRINCE	RFT	100.00
25	3" PVC Pipes (B _ Type)PRINCE	RFT	100.00
26	PVC P- Bend(4")PRINCE	No.	3.00
27	PVC P- Bend(3")PRINCE	No.	3.00
28	PVC Floor Trap(3")PRINCE	No.	3.00
29	PVC Tee(4")PRINCE	No.	3.00
30	PVC Tee(3")PRINCE	No.	3.00

31	PVC double layered Tank (Syntax)	LTR	1,000.00
32	Pump (Crompton Greeves or Eq) 1 HP	No.	1.00
21	Providing and fixing 3 layer PP-R (Poly propylene Random copolymer) pipes conforming to IS: 15801, UV stabilized and anti-microbial fusion welded, having thermal stability for hot and cold water supply including all PP-R plain and brass threaded Polypropylene random fittings. This includes testing of joints complete as per direction of Engineer-in charge		
	A) Internal work-exposed on wall with clamps at 1.00 meter spacing PN-16 pipe , 32mm OD(SDR-7.4)	RM	23.00
	B) Internal work Concealed fixing the pipe with clamps at 1.00 meter spacing including cutting chases and making good the wall etc. PN-16 pipe , 25mm OD(SDR-7.4)	RM	26.00
	EXTERIOR WORKS		
22	Supply & installation- Providing and fixing Roller Blinds with HEAD RAIL chain system drive with ball chain pulley automatically locked on release of ball chain. Plastic idler plug roller tubes corrosion proof outside dia 38mm , bottom rail stiffening element , ball chain acetel balls endless, Fabric 100% Polyester with Width of 2.60 mtrs & vane size is 2" complete to the entire satisfaction of engineer-in-charge (Size of window opening to be measured)	Sqm	15.00
23	P/f of wood work in frames of doors of specific section made out of first kail wood	CFT	7.00
24	MARBLE STONE FLOORING Flooring with marble stone of specified thickness as per sample of marble approved by Engineer-in-charge, over 20 mm (average) thick base of cement mortar 1:4 (1 cement:4 coarse sand) laid and jointed with grey cement slurry including rubbing, polishing and curing complete 16MM Udaipur green marble	SFT	14.00
25	Moulding (marble Work)		
	Moulding of the marble work including grinding and polishing on front nosing including all charges- complete job		
	A) Single	RFT	5.00
26	P/F of 6 mm thick ply (Sainik or eq) CEILING wall including synthetic enamel paint of approved shade / Brand complete.	SFT	60.00
27	Steel work welded in built up sections/framed work, including cutting, hoisting, fixing in position and applying a priming coat of approved steel primer using structural steel etc. as required In gratings, frames, guard bar, ladder, railings, brackets, gates and similar works.	Kgs	136.00
	FURNITURE(LOOSE/ BOUGHT OUT/ ASSEMBLED)		
28	Front Desk		

	(A) M/F of front desk/ running counters of "face to face Type" of approved design and specifications made out of 18mm & 12mm thk plywood (Sainik, Ecotec, Century, Archid or Eq) with 35mm thick post formed top. The front apron of the front desk to be made of 18mm & 12mm thick ply of approved make for Resis of wooden Jali, the front and back side of apron to be finished with 0.8mm thk laminate of approved make (Greenlam,Merino,century or Eq) and shade. The legs of the counter to make in 12mm ply of approved make and finished in 4mm thick American natural walnut Veneer (Make Century, Billion Maglo, Greenply or Eq). Complete job including all hardwares like channel nails,taping,screw etc.(excluding cost of budloo jaali and glasses), All complete	R ft	9.00
	(B) Removing and refixing the existing Front desk table with 12mm thick glass as per the latest interior drawing which includes 35mm thick post formed top merino khaki with 35mm edge banding . The legs of the front desk finished with 4mm thick american natural walnut veneer including key board tray, channel 16" and polish all complte	RFT	17.00
29	Cash Tellers Table		
	Removing and refixing the existing Cash teller table as per the latest interior drawing which includes 35mm thick post formed top merino khaki with 35mm edge banding . The legs of the Cash teller table finished with 4mm thick american natural walnut veneer including polish, hardware all complte.	Rft	9.00
30	Unit Heads Table		
	Manufacturing and supplying a "Unit Head Table" of desired dimensions, made out of 18mm & 12mm plywood (Make Sainik MR, Ecotec MR, Century, Archidply or eq.) with 3" thk top finished in american walnut veneer natural (Make Century, Billion Maglo, Greenply or Eq), side panels and top of table finished in american walnut veneer of approved make polished in melamine of approved shade,with a single line drawer finished internally in 0.8mm laminatel of approved make (Greenlam,Merino,century or Eq) and shade to be provided for keyboard. The front apron and bottom top of table to be finished in 0.8 mm thk laminate of approved make & shade.Complete job including all hardwares like channel nails,taping,screw etc.(excluding cost of budloo jaali and glasses), All complete	S ft	19.00
31	Side Credenza		
	M/S a "Side Credenza" for officers Tables of desired dimensions, outer framework for top and side made out of 18mm plywood (Green Ecotec, Century Sainik, Archid Silvi or Sonear ply or eq), and all exterior faces to be finished in 1mm thk laminate of approved shade 21127 Tan SF Merino lam or 134/2134 Mud Ash suede Greenlam (1mm thick). The drawers are to be fabricated out of 12mm thick plywood (Green Ecotec, Century Sainik, Archid Silvi or Sonear ply or eq). All inner surfaces of framework and drawers are to be finished by 0.8mm laminate of approved brand of white shade. The side credenza shall include single line drawers and bottom storage unit of specified size (Face Area Measurement)	S ft	14.00
32	Sofa with Back		
	Manufacturing and supplying a " Normal Sofa seats in Branch Head Cabin " made out of Well Seasoned Ist Class Budloo Wood of section 3"x1.5" with arm 5"x1.5" and 18mm thick plywood of make(Sainik or eq) with 100mm thick Setting foam and 75mm thick foam for back rest of medium density including cost of necessary hardware mounted with handloom fabric on all sides----Complete Job. (2 seats)	Job	1.00
33	Partition veneer finish		

	P/F american walnut natural veneer partition of make (Make Century, Billion Maglo, Greenply or Eq) having composite thickness of 82mm consisting of frame and double skin 12mm thk plyboard (Make Sainik MR, Ecotec MR, Century, Archidply or eq.) and also double skin 4MM THK American Walnut NATURAL VENEER of approvd make, including P/F of Frame work made of budloo/Fir wood of 2" thkness and 1.5" wide fixed to floor/ ceiling/Wall at a spacing of 600mm c/c by 6mm dia nuts and bolts and studs at both ends, including jointing and finishing to a flush finish with recommended MELAMINE POLISH as per manufacturers specifications all complete.		
	A) Both side veneer partition (frame + both side ply 12mm + both side veneer 4mm + finishing etc)	S ft	95.00
	B) Single side veneer partition (frame + single side ply 12mm + single side veneer 4mm + finishing etc)	sft	53.00
34	Providing and fixing of budloo Jaali 3/4" thick of approved specifications and design fixed in grooves or wodden beading finished all over by French Spirit Polish including a coat of wood filler complete as per specifications, the rate shall include the cost of grooving or provision of wooden beading etc	sft	33.00
35	Storage Racks		
	P/F of storage racks made out of 18mm plywood(Century (Sainik), Greenply (Ecotec), Archidply, Sonear or eq) for stationary room, without shutters, back made out of 6mm thk plywood (Century (Sainik), Greenply (Ecotec), Archidply, Sonear or eq) with 16" x 16" spacing and depth of 16". All outer edges are to be covered with 19mm wide wooden Beeding (Plain) and all internal and external surfaces painted in synthetic enamel of approved color. - complete job including cost of materials and labour (Face area measurement)	S ft	137.00
36	Storage Almirah with Shutters		
	P/F of storage almirah made out of 18mm Plywood (Century (Sainik), Greenply (Ecotec), Archidply, Sonear or eq) including shutters finished in 1mm laminate. All outer sides are to be finished in 1 mm laminate 21127 Tan SF Merino lam or 134/2134 Mud Ash suede Greenlam (1mm thick) and interior sides by 0.8mm laminate of approved brand of white shade. - C J including cost of all materials, locks, 100mm aluminum handles and other accesories and labour (Face area measurement)		
	A) 1'6" depth	S ft	58.00
37	Providing and fixing of flush door shutters, core of block board, single leaf, 35mm thk solid door finished in 1mm thk laminate (century Mica - shade 21127) on all sides and edges - complete job. Including cost of MS Hinges (4")	SFT	116.00
38	Making and doing itching, moulding etc. of different profiles		
	A) Grinding	RFT	131.00
	B) D - Cut holes and SS Wire Managers in glass	NO	3.00
39	P/F of satties made out of 18mm thk plywood (Century, greenlam, archid, kitply or eq.) with back rest with 100mm thk latex rubber pincare sheeting lined on both sides 12 mm medium density polyfoam mounted with handloom fabric -- complete job (Without Arm)	RFT	13.00
40	HARDWARE ITEMS		
	A) Godrej Lock 20cm Long Kadi Tala 6 Levers	No	11.00
	b) handle 150mm SS finish	No	22.00
	c) Tower bolt 150mm ss finish	No	11.00

41	Manufacturing and supplying a "Pedastal Unit" of desired dimensions made out of 18mm plyboard (Make Sainik MR, Ecotec MR, Century, Archidply or eq.) finished in Laminate (Greenlam,Merino,Century or Eq),with a single line drawer finished internally in 0.8mm thk laminate of approved make & shade and pedestal outer sides finished in 1mm thk laminate of approved make & shade with necessary hardware attachments like channels,hydraulic auto hinges,screws etc. Back side of the pedestal to be made of 12mm plywood of approved make. The pedestal shall include the following: a)Single line drawer of size 4.5" x 1' b) Bottom storage of size 1' 6" x 1'	SFT	7.00
----	--	-----	------

42	Wiring for lighting point in 2 x 1.5 sq.mm PVC insulated FR multistrand Copper wire and earthing with 1.5 sq.mm PVC insulated FR multistrand Copper wire through 25mm dia 2 mm thick PVC conduit. Scope shall include Modular Switch, face plate, conduit, junction boxes, MS box, etc. The scope shall also include chiseling work and to make good the losses if any		
	a) Primary point	No	25.00
	b) loop point from existing primary point	No	16.00
43	Wiring for Fan point in 2 x 1.5 sq.mm PVC insulated FR multistrand Copper wire and earthing with 1.5 sq.mm PVC insulated FR multistrand Copper wire through 25mm dia 2 mm thick PVC conduit. Scope shall include Modular Switch, face plate, conduit, junction boxes etc. without MS box. The scope shall also include chiseling work and to make good the losses if any	No	3.00
44	Wiring for Fan point in 2 x 1.5 sq.mm PVC insulated FR multistrand Copper wire and earthing with 1.5 sq.mm PVC insulated FR multistrand Copper wire through 25mm dia 2 mm thick PVC conduit Scope shall include Modular Switch, face plate, conduit, junction boxes etc. with MS box. The scope shall also include chiseling work and to make good the losses if any	No	13.00
45	Wiring for 3 pin 16 A Heating point in 2 x 2.5 sq.mm PVC insulated FR multistrand Copper wire and earthing with 2.5 sq.mm PVC insulated FR multistrand Copper wire through 25mm dia 2 mm thick PVC conduit. The scope shall also include chiseling work and to make good the losses if any. Scope includes 16A switch, 16A socket, MS Box and face plate etc. as per details below :-		
	a) Heating point with less than 11 mtr distance from DB	No	2.00
	b) Loop from existing Heating point point	No	1.00
	c)Heating point with more than 11 mtr distance from DB (<20 mtr)	No	2.00
	d)Heating point with more than 20 mtr distance from DB	No	1.00

46	Wiring for UPS point in 2 x 2.5 sq.mm PVC insulated FR multistrand Copper wire and earthing with 2.5 sq.mm PVC insulated FR multistrand Copper wire through 25mm dia 2 mm thick PVC conduit. The scope shall also include chiseling work and to make good the losses if any. Scope includes Modular switch, Modular socket, MS Box and face plate etc. as per details below :- a) 1 No. 6A socket, 1 No 16A Socket & 1 No. 16A switch from UPS DB	No	1.00
	b) Loop of 1 No. 6A socket, 1 No 16A Socket & 1 No. 16A switch from existing point	No	1.00
	c) 2 No. 6A socket, & 1 No. 16A switch from UPS DB	No	7.00
	d) Loop of 2 No. 6A socket, & 1 No. 16A switch from existing point	No	7.00
	e) 3 No. 6A socket & 1 No. 16A switch from UPS DB	No	2.00
	f) Loop of 3 No. 6A socket & 1 No. 16A switch from existing point	No	1.00
	g) 4 No. 6A socket from UPS DB	No	1.00
47	Supply & fixing of UPS Input Output point consisting of 2 No.16A Sockets on 6 module metal flush box with PVC plate & 2 No. blankers etc. The scope shall also include chiseling work and to make good the losses if any.	No	1.00
48	Wiring for Raw power point in 2 x 2.5 sq.mm PVC insulated FR multistrand Copper wire and earthing with 2.5 sq.mm PVC insulated FR multistrand Copper wire through 25mm dia 2 mm thick PVC conduit. The scope shall also include chiseling work and to make good the losses if any. Scope includes Modular switch, Modular socket, MS Box and face plate etc. as per details below :- a) 1 No 6A Socket & 1 No. 6A switch from RP DB	No	4.00
	b) Loop point of 1 No 6A Socket & 1 No. 6A switch from existing point	No	4.00
	c) 2 No. 6A socket, 1 No. 16A switch from RP DB	No	3.00
	d) Loop of 2 No. 6A socket, 1 No. 16A switch from existing point	No	2.00
	Providing & fixing of PVC insulated FR multistrand copper wire		
49	a) 1.5 sq mm	Mtr	300.00
	b) 2.5 sq mm	Mtr	210.00
	c) 4.0 sq mm	Mtr	100.00
	d) 6.0 sq mm	Mtr	210.00
	e) 10.0 sq mm	Mtr	5.00
50	Providing and fixing of 2 Core x 35 sq. mm. unarmoured Aluminium Cable 1100 V grade as required. The scope includes laying the cable by clamping in the wall, laying in the soil etc. as required and cable end terminations with suitable size lugs and glands	Mtr	45.00

51	Supply, Laying & fixing of Cat 6 Data Cable in existing PVC conduit including termination charges	Mtr	680.00
52	Supply, laying & fixing of PVC insulated 2 pair Telephone copper wire in existing PVC Conduit	Mtr	300.00
53	Supply & Laying of medium-Grade PVC Conduit of 25 mm dia & 2 mm thickness	Mtr	325.00
54	Supply & Laying of 25mm flexible pipe	Mtr	5.00
55	Supplying, installation, testing and laying of 8 SWG bare Copper wire for Earthing	Mtr	12.00
56	Providing, fixing, installation, commissioning & testing of 1' x 1', 24 Watt, recess Square LED lighting fixtures	No	26.00
57	Providing, fixing, installation, commissioning & testing of 6", 15 Watt, LED Recess Round lighting fixtures	No	4.00
58	Providing, fixing, installation, commissioning & testing of 4 feet LED Batten 18W or above	No	10.00
59	Providing, fixing, installation, commissioning & testing of 2 feet LED Batten	No	1.00
60	Supply, installation, commissioning & testing of 400 mm wall fan	No	7.00
61	Supply, installation, commissioning & testing of 300 mm Cabin fan	No	2.00
62	Supply, installation, commissioning & testing of 150 mm Exhaust fan	No	4.00
63	Supply, installation, commissioning & testing of 300 mm Metallic Exhaust fan	No	2.00
64	Supply, installation, commissioning & testing of RJ-45 Krone networking data jack including face plate with 1 No. RJ-45 jack including 1/2 module plate	No	20.00
65	Supply, installation, commissioning & testing of RJ-11 Telephone jacks including face plate with 1 No. RJ-11 jack including 1 module plates	No	10.00
66	Supply, installation, testing and commissioning of following items for Rack		
	a) Supply, installation, testing and commissioning of fully loaded 12 U Networking Rack. Fully loaded includes axial exhaust fans, Hardware packet, cable Manager, 5 No. 6A Sockets, 1U cantilever Shelf tray etc.	No	1.00
	b) Supply, installation, testing and commissioning of Fully Loaded 24 port Patch Panel	No	1.00
	c) Supply & fixing of Patch Cords		
	i) 1 Meters	No	24.00
	ii) 2 Meters	No	12.00
67	Supply, installation, testing and commissioning of 6 way double Door (TPN) Distribution Board (8+18)	No	2.00
68	Supply & fixing of MCCB/ MCB as per detail:-		

	a) MCCB TP 100 A 10KA	No	1.00
	b) MCB DP 63A/ 40A, 10KA C curve	No	0.00
	c) MCB DP 6 - 32A, 10KA C curve	No	11.00
	d) MCB SP 6 - 32A, 10KA C curve	No	26.00
69	Rate for fabrication, supply, installation, testing and commissioning of compact cubical indoor type dust proof sheet steel powder coated LT switchgear panel suitable for 440 V, 3 phase 4 wire, 50 Hz PANEL power distribution system complete with cable inter connections, Al Bus Bar (TPN) & other accessories (per cuft).		
	3x3x1	cuft	9.00
70	Providing & fixing of 100A FP Changeover	No	2.00
71	Supply & fixing of 32A DP on-load changeover (side handle type)	No	1.00
72	Supply & fixing of Voltmeter in panel	No	1.00
73	Supply & fixing of Indicator in panel	No	3.00
	Supply & fixing of thimbles		
74	a) Cu/Aluminium thimbles (2.5/4/6sqmm)	No	160.00
	b) 35 sqmm Aluminium thimbles	No	6.00
75	Supply & fixing of 3 pin 6A top	No	6.00
76	Supply & fixing of 3 pin 16A top	No	2.00
77	Supply & fixing of ferule	No	190.00
78	Labour charges for Electricians	No	2.00
79	Supply & fixing of Ceiling rose with PVC block	No	10.00
80	SITC of Earthing station as called for in 2m x 50mm GI Pipe with Copper Electrode of 2100mmx25mmx6mm with requisite Back fill compound (2 bags of 15kg/ 30kg (1 bag)) acting as moisture booster ground enhancement material placed all around the electrode in a bore of minimum diameter of 5 inch to make a safe maintenance free chemical earthing. The whole assembly should be covered by a Cast Iron main hole cover fitted in concrete mixture of 4:1. around 6" perimeter and 6" depth. The copper electrode should be provided with Nut and bolt of Brass with Copper thimble of appropriate size.	No	2.00
81	Supply, installation, testing and commissioning of 4 zone intrusion panel including 12 V battery capable of providing backup of 24 hrs. with key operations, LED indicators, capable to connect with high voltage siren & in built digital communicator for i) CMS connectivity through LAN & Telephone ii) Micro pro controller based inbuilt speech auto dialer	No	1.00
82	Supply, installation, testing and commissioning of Hand operated Panic switch for security alarm system	No	7.00

83	Supply, installation, testing and commissioning of PIR motion sensor for security alarm system	No	2.00
84	Supply, installation, testing and commissioning of Beacon lights for security alarm system	No	1.00
85	Supply, installation, testing and commissioning of Hooter for security alarm system	No	2.00
86	Supply, installation, testing and commissioning of main control panel (Fire Alarm) with battery back up of 16 hrs. with 2No. 12V battery (2 Zone)	job	1.00
87	Supply, installation, testing and commissioning of smoke detectors	No.	19.00
88	Supply, installation, testing and commissioning of heat detectors	No.	1.00
89	Supply, installation, testing and commissioning of strobes/Horns	No.	2.00
90	Providing and fixing of Response Indicator	No.	3.00
91	Supply, installation, testing and commissioning of Manual call point	No.	2.00

Annexure B

Drawing

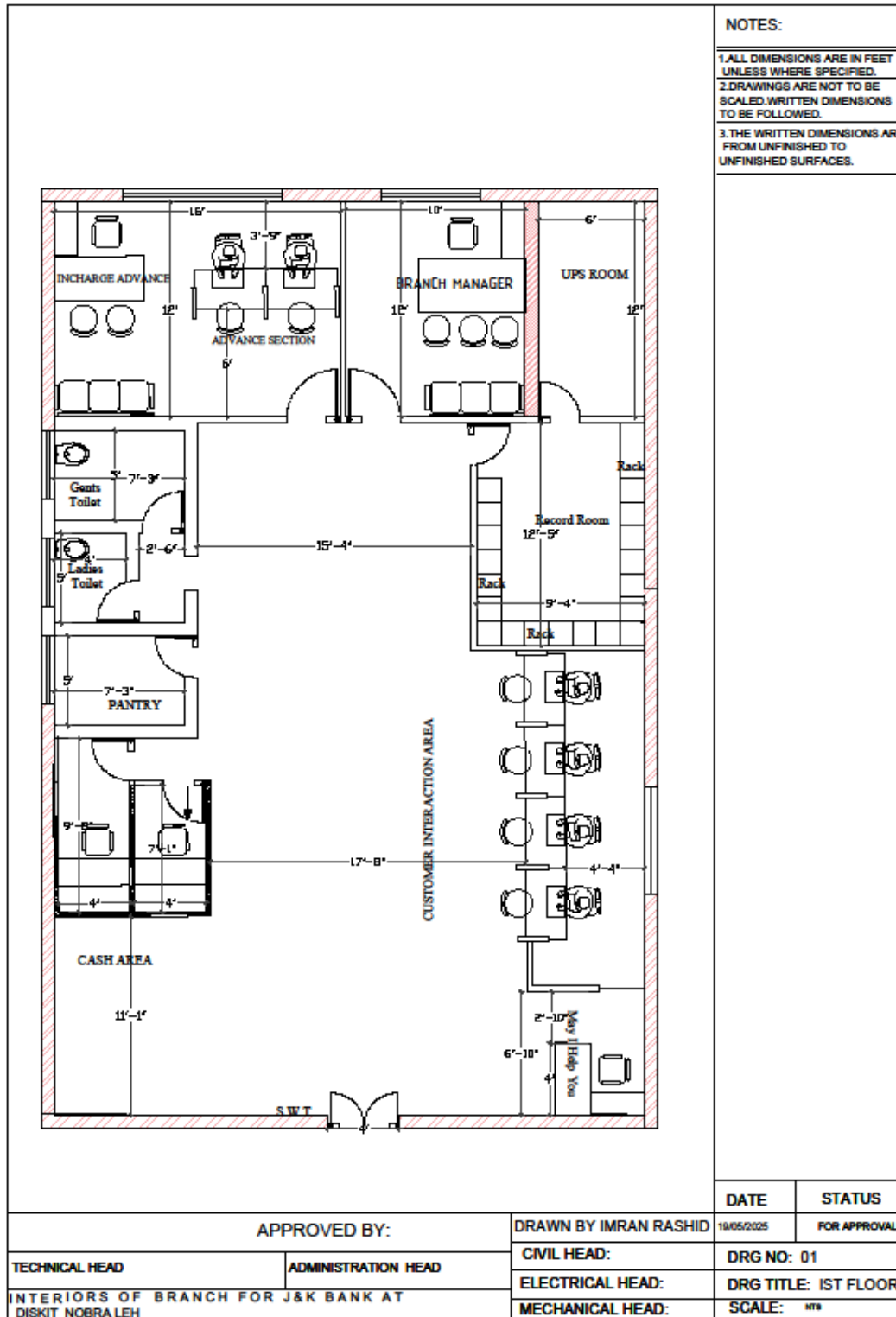

Annexure C
LIST OF APPROVED MAKES

LIST OF MAKES OF DIFFERENT MATERIALS REQUIRED FOR DEVELOPMENT OF BUSINESS UNITS		
S. No	Description	Approved Brands to be used
INTERIOR AND FURNITURE ITEMS		
1	Plywood	Greenply (Ecotec), Century (Sainik), Archidply,
2	Veneers	American Walnut Natural Veneer 4mm thick basic cost Rs 2800 per sheet of size 8'-0" x 4'-0" (Make Century, Billion Maglo, Greenply or Eq)
3	Laminates	Merino, Greenlam, Century, Archid
4	Gypsum Board	Lafarge, Saint Gobain (Gyproc).USG Boral
5	Gyp frame for Gyp Ceiling	Gyproc, Armstrong
6	Cement	Khyber, Ambuja Cements, Ultratech, ACC
7	Vitrified Tiles (Full Body Premium Quality)	Kajaria, Jhonson, RAK
8	Ceramic Tiles	Nitco, Kajaria, RAK,Jhonson
9	Wall Putty	Birla, JK or eq
10	Plastic Emulsion	Asian paints, Nerolac, Dulux,
11	Synthetic enamel	Asian paints, Nerolac, Dulux,
12	Cement primer	Asian paints, Nerolac, Dulux,
13	Wood primer	Asian paints, Nerolac, Dulux,
14	Patch Fittings	Ozone (8400), Dorma (BTS 65), Enox
15	Dead Locks / Hardware	Godrej, Hettich, Ozone, link
16	G.I Pipes	B - Class; Prakash Surya, Jindal, Tata
17	PVC Pipes	B- Type; Finolex, Astral, Prince, Supreme or eq
18	Structural Steel	Jindal, Data, Atlas
19	Reinforcement Steel	Jindal, Shakti, Kamdhenu
20	FLOAT GLASS/Toughened Glass	Asahi, Saint Gobain, Gold Plus
21	Pump	Crompton Greeves, Kirloskar
22	Hot Water Geyser	Venus, Crompton, Havells, Bajaj, Racold, Jaquar, Morphy Richards
23	Sanitary Items	Jaquar, Hindware, Cera, Parryware
24	SS Railing	Grade 304 for interior works
25	Roller Blinds	Vista, MAC or eq
26	Aluminum Sections	16 Guage
27	Aluminum Composite panels	ALSTONE, EUROBOND , Viva

ELECTRICAL ITEMS		
1	Lighting Fixtures	Philips/ Wipro / Crompton
2	Wires	Havells/Finolex/RR Kabel/Paramount
3	Telephone wires	Havells/Finolex/RR Kable
4	Cables	Havells/Finolex/Gloster/KEI/Paramount/
5	Data Cable	D-link/Legrand/Amp/Finolex
6	Data Jacks	Legrand Mylinc/North west NOWA/Schneider Livia
7	Telephone Jacks	Legrand Mylinc/North west Nowa/Schneider Livia
8	Switch Series	Legrand Mylinc/North west Nowa/Schneider Livia/Crabtree Murano
9	MCB	Legrand Mylinc/ Schneider Acti9/Crabtree Xpro/L&T /ABB
10	MCCB	Legrand Mylinc/ Schneider Acti9/DU-D-Sine L&T/
11	Changeover	Havells/HPL/Socomec/
12	Fans	Havells/Crompton Greaves/Standard
13	Conduits (Medium grade)	Prince/Polycab/Finolex/Alba Green
14	Distribution Boards	Legrand Ekinox /Crabtree XPRO/Schneider Acti9
15	CCTV cable	Havells/RR Kabel/Polycab/D-Link
16	Chemical Earthing	ASH/JINDAL/JMV/ERICO
17	Patch Cord	D-Link/DigiLink Schneider/Legrand
18	Networking Rack	Comrack/D-Link/Dynamic/Legrand
19	Security Alarm Panel	Honeywell/ NS/ Securico
20	Panic Switch	Honeywell/ NS/ Securico
21	Magnetic contacts	Honeywell/ NS/ Securico
22	Motion detectors	Honeywell/ NS/ Securico
23	Electronic sirens	Honeywell/ NS/ Securico
24	Beacon lights	Honeywell/ NS/ Securico
FIRE ALARM ITEMS		
25	Smoke Detector	Apollo/GE/ System Sensor or Equivalent
26	Heat Detector	Apollo/GE/ System Sensor or Equivalent
27	Manual Call Point	Agni/Apollo/GE/ System Sensor or Equivalent
28	Hooter	Agni/Apollo/GE/ System Sensor or Equivalent
29	Response Indicator	Agni/Apollo/GE/ System Sensor or Equivalent
30	Main control panel	System Sensor/Agni/Siemens/Nitin or Equivalent

Annexure D
COMMERCIAL / PRICE BID FORMAT FOR COMPOSITE WORKS

Composite Works.					
S. No.	PARTICULARS OF ITEMS SPECIFICATIONS AS PER ANNEXURE -A	Unit	Quantity	Rate	AMOUNT
	A) Dismantaling of Existing Gyp Partition	SFT	783.62		
	B) Dismantaling of Existing Floor tile /Wall tiles/Granite	SFT	1,874.62		
	C) Removing of existing Panelled /Glazed/ Flush doors doors	SFT	147.00		
	D) Dismantaling of Existing brick work/block work	CUM	3.00		
1	Cement Concrete				
	Providing and laying of cement concrete with crushed stone aggregates				
	A) 1:3:6 (1 cement : 3coarse sand : 6 crushed stone aggregate 20mm n/s)	Cu m	9.00		
	B) 1:1.5:3 (Crushed stone 20mm nominal size)	Cum	0.73		
2	Steel reinforcement for R.C.C. work including straightening, cutting, bending, placing in position	Kgs	47.00		
3	Centering and shuttering including strutting, propping etc. and removal of form work for: Foundations, footings, bases for columns	SQM	1.00		
4	Providing and laying of stone soling/boulders tightly handpacked under foundations, footings etc.	CUM	2.00		
5	Solid Block masonry work				
	Providing and fixing upto floor five level precast cement concrete solid blocks	Cum	9.00		
6	Plaster Works				
	CEMENT PLASTER (IN FINE SAND) 12mm Cement plaster of mix: 1 : 6 (1 cement : 6 fine sand)	SQM	115.0		
7	Vitrified Tiles				
	Providing and laying full body glazed polished vitrified tile free from all visible defects of size 600x600	SFT	1,731.00		
	B) Same as above "A" in Skirting 4 " Height	RFT	348.00		
8	Ceramic Tiles				

	P/L of Ceramic Tiles free from all visible defects walls tiles of size 450x300mm and matching floor 300 x 300mm of 1st quality	SFT	439.00		
9	POP WORKS				
	Providing and doing 6mm thick POP over walls only	SFT	2,164.00		
10	Gyp Ceiling				
	P/F of gyp board ceiling (Gyproc, USG Boral or eq) 12.5 mm thk over frame work with G.I suspended metal	SFT	1,650.00		
11	Partition, Gyp Finish				
	P/F of Partition having composite thickness of 99mm consisting of frame and double skin 12mm thk plywood	SFT	367.00		
12	Providing and Doing 1mm thick Wall putty over Gyp ceiling and Gyp Partition	SFT	2,384.00		
13	P/f of frame work of fir wood / pinewood / hardwood for connecting gyp partitions to ceiling	SFT	56.00		
14	P/F of Beeding (3.5 inches wide) on the joints of gyp and glass in partitions	RFT	140.00		
15	Providing and fixing of half glazed and half laminated shutter for doors using 5mm thick float glass	SFT	75.00		
16	P/F of float glass in doors , windows and furniture tops but excluding moulding, grinding, itching etc. 12mm Thickness	SFT	122.00		
	PAINTING AND FINISHING WORKS				
17	Applying three coats of plastic emulsion (Morning Glory Shade no 0765 & (TWINKLING STARS SHADE NO 8466) of approved brand				
	A) With Priming Coat	Sq.M	452.00		
18	Painting with synthetic enamel paint of approved brand and manufacture to give an even shade. Two or more coats on new work				
	A) With Priming Coat	Sq.m	24.00		
19	Finishing walls with acrylic smooth exterior paint of required shade on New work (Two or more coats applied @ 1.67 liter/10sqm				
	A) With Priming Coat	Sq.M	120.00		
	PLUMBING AND SANITARY WORKS				
20	Sanitary items				
1	Providing and fixing vitreous china wash basin including making all connections	No.	1.00		
2	Supply, installation, testing and commisioning of hot water electrical operated Geyser of approved make,				

	i) Capacity 35 ltrs	No.	2.00		
	ii) Capacity 25 ltrs	No.	0.00		
3	CP Wall / Basin Mixer (Jaquar(continental), Hindware, Cera (Ocean) or eq)	No.	4.00		
4	CP Angle valve (Jaquar(continental), Hindware, Cera (Ocean) or eq)	No.	8.00		
5	C P Gratting (Jaquar(continental), Hindware, Cera (Ocean) or eq)	No.	2.00		
6	C P Towel Ring (6" Dia) (Jaquar(continental), Hindware, Cera (hera) or eq)	No.	2.00		
7	C P Towel Rod (1' - 6" length) (Jaquar(continental), Hindware, Cera (Oakla) or eq)	No.	2.00		
8	Beab Cock, long nose / short nose (Jaquar(continental), Hindware, Cera (Ocean) or eq)	No.	2.00		
9	Tissue paper Holder (Jaquar(continental), Hindware, Cera (aromond) or eq)	No.	2.00		
10	PVC Cistern (White Shade), (Jaquar(continental), Hindware, Cera (Ocean) or eq)	No.	2.00		
11	PVC Connections (15mm Dia) 1' -6" Length	No.	8.00		
12	CP Cups (Jaquar(continental), Hindware, Cera (Ocean) or eq)	No.	7.00		
13	CP Soap Case (Jaquar(continental), Hindware, Cera (Oakla) or eq)	No.	3.00		
14	CP Hanger (6 No. Hooks) (Jaquar(continental), Hindware, Cera (aromond) or eq)	No.	2.00		
15	5mm mirror fixed on spacers	No.	1.00		
16	CP Long Bend	No.	2.00		
17	PVC Waste Pipe	No.	2.00		
18	PVC P _ Trap (4") (B- Type, Finolex, Astral, Prince, Supreme or eq)	No.	2.00		
19	PVC Floor Trap(3") (B- Type, Finolex, Astral, Prince, Supreme or eq)	No.	3.00		
20	Health Faucet (Jaquar, Hindware, Cera or eq)	No.	2.00		
21	Indian WC White shade (Parryware, Hindware, Cera or eq)	No.	2.00		
22	Glass shelf below mirror	No.	2.00		
23	CP waste Coupling	No.	2.00		
24	4" PVC Pipes (B- Type) PRINCE	RFT	100.00		
25	3" PVC Pipes (B _ Type)PRINCE	RFT	100.00		
26	PVC P- Bend(4")PRINCE	No.	3.00		
27	PVC P- Bend(3")PRINCE	No.	3.00		

28	PVC Floor Trap(3")PRINCE	No.	3.00		
29	PVC Tee(4")PRINCE	No.	3.00		
30	PVC Tee(3")PRINCE	No.	3.00		
31	PVC double layered Tank (Syntax)	LTR	1,000.00		
32	Pump (Crompton Greeves or Eq) 1 HP	No.	1.00		
21	Providing and fixing 3 layer PP-R (Poly propylene Random copolymer) pipes conforming to IS: 15801				
	A) Internal work-exposed on wall with clamps at 1.00 meter spacing PN-16 pipe , 32mm OD(SDR-7.4)	RM	23.00		
	B) Internal work Concealed fixing the pipe with clamps at 1.00 meter spacing including cutting chases and making good the wall etc. PN-16 pipe , 25mm OD(SDR-7.4)	RM	26.00		
	EXTERIOR WORKS				
22	Supply & installation- Providing and fixing Roller Blindes with HEAD RAIL chain system drive with ball chain pulley	Sqm	15.00		
23	P/f of wood work in frames of doors of specific section made out of first kail wood	CFT	7.00		
24	MARBLE STONE FLOORING Flooring with marble stone of specified thickness as per sample of marble approved by Engineer-in-charge,	SFT	14.00		
25	Moulding (marble Work)				
	Moulding of the marble work including grinding and polishing on front nosing including all charges- complete job				
	A) Single	RFT	5.00		
26	P/F of 6 mm thick ply (Sainik or eq) CEILING wall including synthetic enamel paint of approved shade / Brand complete.	SFT	60.00		
27	Steel work welded in built up sections/framed work, including cutting, hoisting, fixing in position	Kgs	136.00		
A	FURNITURE(LOOSE/ BOUGHT OUT/ ASSEMBLED)				
28	Front Desk				
	(A) M/F of front desk/ running counters of "face to face Type" of approved design and specifications made out of 18mm & 12mm thk plywood	R ft	9.00		
	(B) Removing and refixing the existing Front desk table with 12mm thick glass as per the latest interior drawing	RFT	17.00		
29	Cash Tellers Table				

.	Removing and refixing the existing Cash teller table as per the latest interior drawing which includes 35mm thick post formed top	Rft	9.00		
30	Unit Heads Table				
	Manufacturing and supplying a "Unit Head Table" of desired dimensions, made out of 18mm & 12mm plywood	S ft	19.00		
31	Side Credenza				
	M/S a "Side Credenza" for officers Tables of desired dimensions, outer framework for top and side made out of 18mm plywood	S ft	14.00		
32	Sofa with Back				
	Manufacturing and supplying a " Normal Sofa seats in Branch Head Cabin " made out of Well Seasoned Ist Class Budloo Wood Complete Job. (2 seats)	Job	1.00		
33	Partition veneer finish				
	P/F american walnut natural veneer partition of make having composite thickness of 82mm consisting of frame				
	A) Both side veneer partition (frame + both side ply 12mm + both side veneer 4mm + finishing etc)	S ft	95.00		
	B) Single side veneer partition (frame + single side ply 12mm + single side veneer 4mm + finishing etc)	sft	53.00		
34	Providing and fixing of budloo Jaali 3/4" thick of approved specifications and design fixed in grooves or wodden beading	sft	33.00		
35	Storage Racks				
	P/F of storage racks made out of 18mm plywood for stationary room, without shutters, back made out of 6mm thk plywood	S ft	137.00		
36	Storage Almirah with Shutters				
	P/F of storage almirah made out of 18mm Plywood including shutters finished in 1mm laminate.				
	A) 1'6" depth	S ft	58.00		
37	Providing and fixing of flush door shutters, core of block board, single leaf, 35mm thk solid door finished in 1mm thk laminate (century Mica - shade 21127) on all sides and edges - complete job. Including cost of MS Hinges (4")	SFT	116.00		
38	Making and doing itching, moulding etc. of different profiles				
	A) Grinding	RFT	131.00		
	B) D - Cut holes and SS Wire Managers in glass	NO	3.00		
39	P/F of satties made out of 18mm thk plywood with back rest with 100mm thk latex rubber pincare sheeting lined on both	RFT	13.00		
40	HARDWARE ITEMS				
	A) Godrej Lock 20cm Long Kadi Tala 6 Levers	No	11.00		
	b) handle 150mm SS finish	No	22.00		
	c) Tower bolt 150mm ss finish	No	11.00		

41	Manufacturing and supplying a "Pedastal Unit" of desired dimensions made out of 18mm plyboard finished in Laminate	SFT	7.00		
42	Wiring for lighting point				
	a) Primary point	No	25.00		
	b) loop point from existing primary point	No	16.00		
43	Wiring for Fan point without box	No	3.00		
44	Wiring for Fan point with MS box	No	13.00		
45	Wiring for 3 pin 16 A Heating point in 2.5 sqmm				
	a) with less than 11 mtr distance from DB	No	2.00		
	b) Loop with less than 11 mtr distance from existing point	No	1.00		
	c) with more than 11 mtr distance from DB (<20 mtr)	No	2.00		
	d) with more than 20 mtr distance from DB	No	1.00		
46	Wiring for UPS point				
	a) 1 No. 6A socket, 1 No 16A Socket & 1 No. 16A switch from UPS DB	No	1.00		
	b) Loop of 1 No. 6A socket, 1 No 16A Socket & 1 No. 16A switch from existing point	No	1.00		
	c) 2 No. 6A socket, & 1 No. 16A switch from UPS DB	No	7.00		
	d) Loop of 2 No. 6A socket, & 1 No. 16A switch from existing point	No	7.00		
	e) 3 No. 6A socket & 1 No. 16A switch from UPS DB	No	2.00		
	f) Loop of 3 No. 6A socket & 1 No. 16A switch from existing point	No	1.00		
	g) 4 No. 6A socket from UPS DB	No	1.00		
47	Supply & fixing of UPS Input Output point	No	1.00		
48	Wiring for Raw power point				
	a) 1 No 6A Socket & 1 No. 6A switch from RP DB	No	4.00		
	b) Loop point of 1 No 6A Socket & 1 No. 6A switch from existing point	No	4.00		
	c) 2 No. 6A socket, 1 No. 16A switch from RP DB	No	3.00		

	d) Loop of 2 No. 6A socket, 1 No. 16A switch from existing point	No	2.00		
49	Providing & fixing of PVC insulated copper wire				
	a) 1.5 sq mm	Mtr	300.00		
	b) 2.5 sq mm	Mtr	210.00		
	c) 4.0 sq mm	Mtr	100.00		
	d) 6.0 sq mm	Mtr	210.00		
	e) 10.0 sq mm	Mtr	5.00		
50	SITC of 2 Core x 35 sq. mm. unarmored Aluminum Cable	Mtr	45.00		
51	Supply, Laying & fixing of Cat 6 Data Cable	Mtr	680.00		
52	Supply, laying & fixing of 2 pair Telephone copper wire	Mtr	300.00		
53	Supply & Laying of PVC Conduit	Mtr	325.00		
54	Supply & Laying of flexible pipe	Mtr	5.00		
55	Supplying, installation, testing and laying of 8 SWG bare Copper wire for Earthing	Mtr	12.00		
56	Providing, fixing, installation, commissioning & testing of 1' x 1', 24 Watt, recess Square LED lighting fixtures	No	26.00		
57	Providing, fixing, installation, commissioning & testing of 6", 15 Watt, LED Recess Round lighting fixtures	No	4.00		
58	Providing, fixing, installation, commissioning & testing of lighting fixtures 4 Feet LED Batten	No	10.00		
59	Providing, fixing, installation, commissioning & testing of lighting fixtures 2 Feet LED Batten	No	1.00		
60	SITC of 400 mm wall fan	No	7.00		
61	SITC of 300 mm Cabin fan	No	2.00		
62	SITC of 150 mm Exhaust fan	No	4.00		
63	SITC of 300 mm Metallic Exhaust fan	No	2.00		
64	SITC of Networking data Jack	No	20.00		
65	SITC of Telephone jacks	No	10.00		
66	SITC of following items for Rack				

	a) 12 U Networking Rack	No.	1.00		
	b) 24 port Fully Loaded Patch Panel	No.	1.00		
	c) Patch Cords				
	i) 1 Meters	No	24.00		
	ii) 2 Meters	No	12.00		
67	SITC of 6 way double Door (TPN) DB (8+18)	No	2.00		
	Supply & fixing of MCCB/ MCB as per detail:-				
	a) MCCB TP 100 A	No	1.00		
68	d) MCB DP 63A/ 40A, 10KA	No	0.00		
	c) MCB DP 6 - 32A, 10KA	No	11.00		
	d) MCB SP 6 - 32A, 10KA	No	26.00		
69	Rate for fabrication, supply, installation, testing and commissioning of compact cubical indoor type dust proof sheet steel powder coated LT switchgear panel Size:- 3'x3'x1'	cuft	9.00		
70	Providing & fixing of 100A FP Changeover	No.	2.00		
71	Supply & fixing of 32A DP on-load changeover (side handle type)	No.	1.00		
72	Supply & fixing of Voltmeter in panel	No.	1.00		
73	Supply & fixing of indicator in panel	No	3.00		
	Supply & fixing of thimbles				
74	a) Cu/Aluminum thimbles (2.5/4/6sqmm)	No	160.00		
	b) 35 sqmm Aluminum thimbles	No	6.00		
75	Supply & fixing of 3 pin 6A top	No	6.00		
76	Supply & fixing of 3 pin 16A top	No	2.00		
77	Supply & fixing of ferule	No	190.00		
78	Electrician Charges	No	2.00		
79	Supply & fixing of ceiling rose with PVC block	No	10.00		

80	SITC of Chemical Earthing station(s)	No	2.00		
81	Supply, installation, testing and commissioning of 4 zone intrusion panel including 12 V battery capable of providing backup of 24 hrs. with key operations, LED indicators, capable to connect with high voltage siren & in built digital communicator for i) CMS connectivity through LAN & Telephone ii) Micro pro controller based inbuilt speech auto dialer	No	1.00		
82	Supply, installation, testing and commissioning of Hand operated Panic switch for security alarm system	No	7.00		
83	Supply, installation, testing and commissioning of PIR motion sensor for security alarm system	No	2.00		
84	Supply, installation, testing and commissioning of Beacon lights for security alarm system	No	1.00		
85	Supply, installation, testing and commissioning of Hooter for security alarm system	No	2.00		
86	Supply, installation, testing and commissioning of main control panel (Fire Alarm) with battery back up of 16 hrs. with 2No. 12V battery (2 Zone)	job	1.00		
87	Supply, installation, testing and commissioning of smoke detectors	No.	19.00		
88	Supply, installation, testing and commissioning of heat detectors	No.	1.00		
89	Supply, installation, testing and commissioning of strobes/Horns	No.	2.00		
90	Providing and fixing of Response Indicator	No.	3.00		
91	Supply, installation, testing and commissioning of Manual call point	No.	2.00		
Total					
Discount if Any (%)					
Net after Discount					
Add GST @ 18%					
Grand total including GST (Rs.)					